

MANUAL VALVES AND LOCKSHIELDS

te-sa radiator valves and lockshields valves are specifically designed for adjustment and interception of the heat transfer fluid in heating systems.

The range includes versions for iron, copper, PEX and multilayer pipe (1/2" and 3/4"E connections for screw-on fittings).

They feature a special-profile rubber gasket on the union that enables connection of the valves and lockshields to all radiators without additional sealing elements.



Technical specifications

Materials:

- Body: Brass UNI EN 12165 - CW617N
- Insert valve: Brass UNI EN 12164 - CW614N
- Seals: EPDM Peroxide
- Valve knob: ABS (RAL 9010)
- Lockshield cap: ABS (RAL 9010)

Operation:

- Usable fluids: Water – Glycolated solutions
- Maximum glycol. percentage: 30%
- Maximum operating pressure: 10 bar
- Maximum operating temperature: 100°C



Products range:

Valves for iron pipe:

Art. 100/1	Manual angle valve	sizes 3/8", 1/2", 3/4"
Art. 101/1	Angle lockshield	sizes 3/8", 1/2", 3/4"
Art. 102/1	Manual straight valve	sizes 3/8", 1/2", 3/4"
Art. 103/1	Straight lockshield	sizes 3/8", 1/2", 3/4"

Valves for copper and multilayer pipes

Art. 104/1	Manual angle valve	sizes 3/8", 1/2", 1/2" x 3/4"E
Art. 105/1	Angle lockshield	sizes 3/8", 1/2", 1/2" x 3/4"E
Art. 106/1	Manual straight valve	sizes 3/8", 1/2", 1/2" x 3/4"E
Art. 107/1	Straight lockshield	sizes 3/8", 1/2", 1/2" x 3/4"E

Rubber seal

The radiator connection unions feature a special profile rubber gasket that enables simple, rapid and secure installation.

Made from EPDM Peroxide, the gasket requires no additional sealing elements such as hemp fiber or PTFE tape etc.

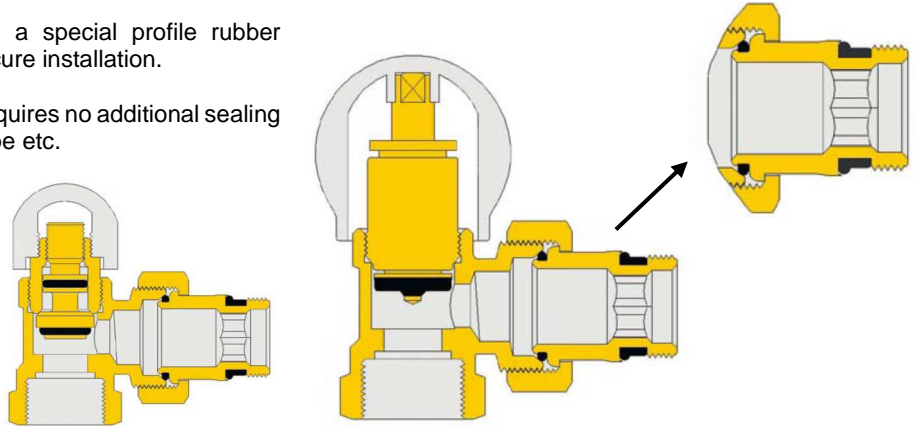

Dimensions and pressure losses

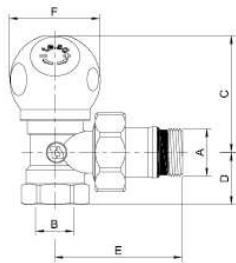

Art.	A	B	C	D	E	F
100/1-03	3/8"	3/8"	49	20	50	Ø39
100/1-04	1/2"	1/2"	49	23	54	Ø39
100/1-05	3/4"	3/4"	49	26	60	Ø39

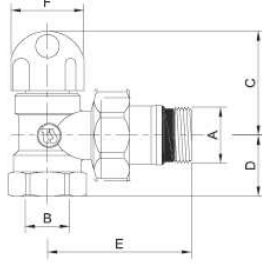

Art.	A	B	C	D	E	F
101/1-03	3/8"	3/8"	39	20	50	Ø27
101/1-04	1/2"	1/2"	39	23	54	Ø27
101/1-05	3/4"	3/4"	39	26	60	Ø27
101/1-06	1"	1"	42	31	76	Ø27

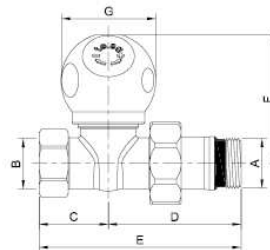

Art.	A	B	C	D	E	F	G
102/1-03	3/8"	3/8"	30	50	80	57	Ø39
102/1-04	1/2"	1/2"	28	54	82	57	Ø39
102/1-05	3/4"	3/4"	28	57	85	57	Ø39

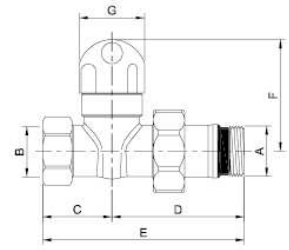

Art.	A	B	C	D	E	F	G
103/1-03	3/8"	3/8"	30	50	80	45	Ø27
103/1-04	1/2"	1/2"	28	54	82	45	Ø27
103/1-05	3/4"	3/4"	28	57	85	45	Ø27

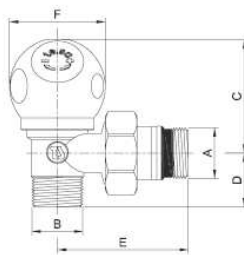

Art.	A	B	C	D	E	F
104/1-03	3/8"	1/2"	49	20	49	Ø39
104/1-04	1/2"	1/2"	49	23	56	Ø39
104/1-045	1/2"	3/4"	49	22	61	Ø39

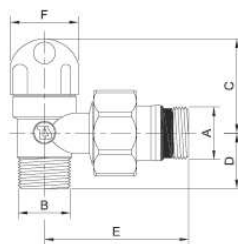

Art.	A	B	C	D	E	F
105/1-03	3/8"	1/2"	41	20	49	Ø27
105/1-04	1/2"	1/2"	41	23	56	Ø27
105/1-045	1/2"	3/4"	41	22	61	Ø27

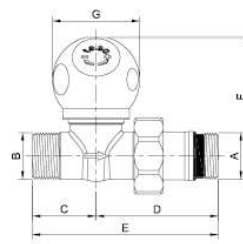

Art.	A	B	C	D	E	F	G
106/1-03	3/8"	1/2"	30	50	80	57	Ø39
106/1-04	1/2"	1/2"	30	53	83	57	Ø39
106/1-045	1/2"	3/4"	28,5	58	86,5	57	Ø39

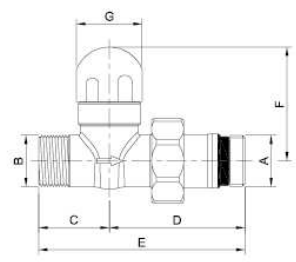

Art.	A	B	C	D	E	F	G
107/1-03	3/8"	1/2"	30	50	80	44	Ø27
107/1-04	1/2"	1/2"	30	53	83	44	Ø27
107/1-045	1/2"	3/4"	29	58	87	44	Ø27

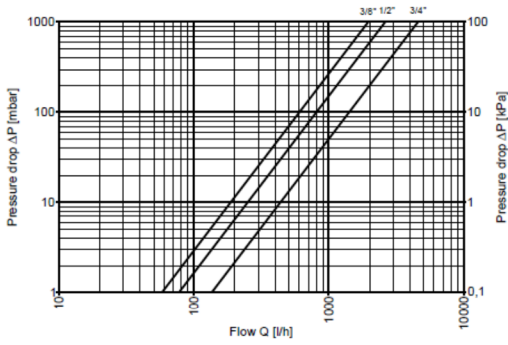

serie 100/1-03-04-05

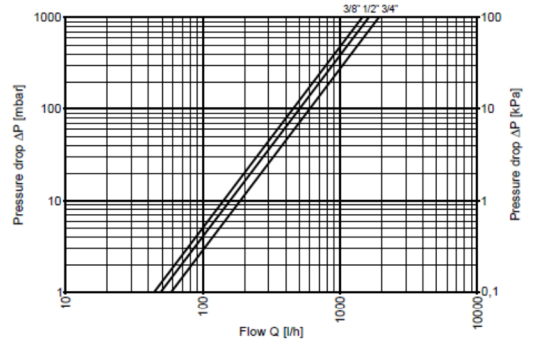

serie 102/1-03-04-05

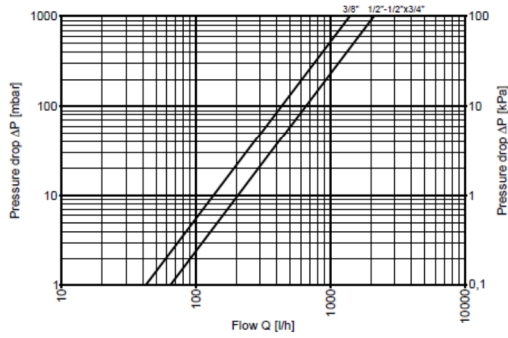

serie 104/1-03-04-045

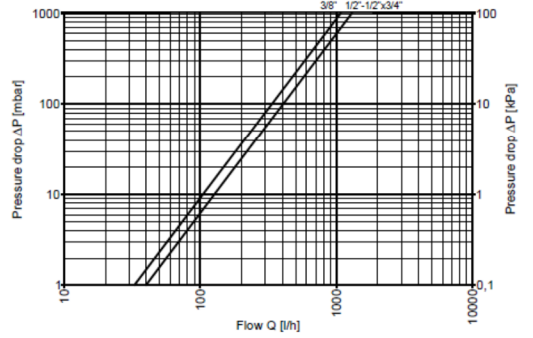

serie 106/1-03-04-045

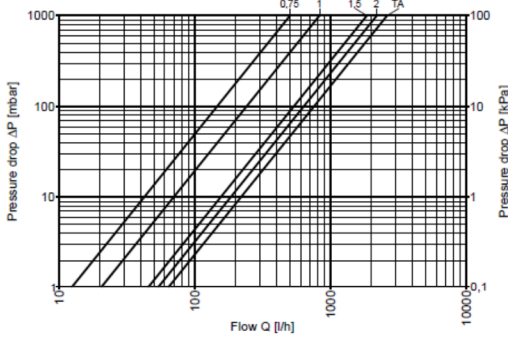

serie 101/1-03

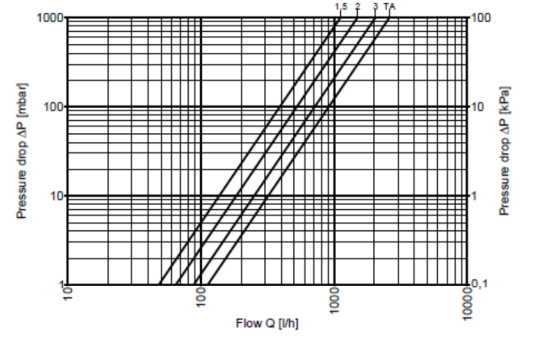

serie 101/1-04

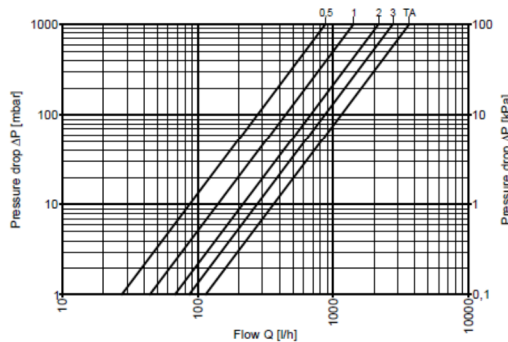

serie 101/1-05

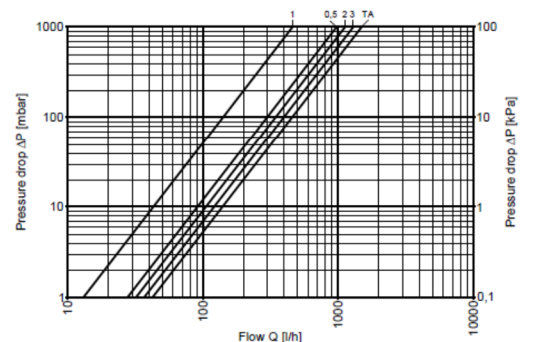

serie 103/1-03

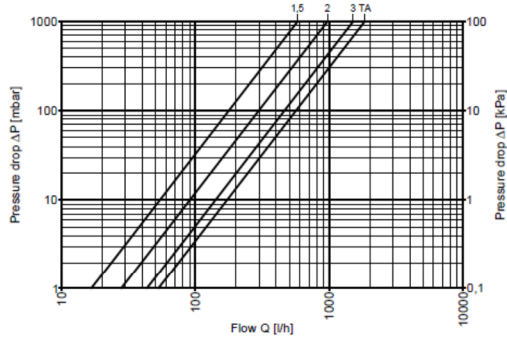

serie 103/1-04

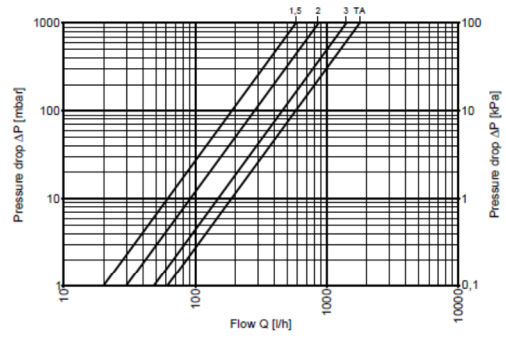

serie 103/1-05

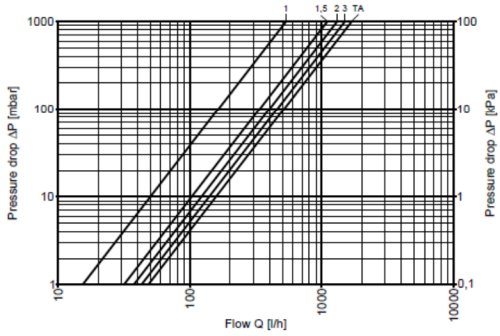

serie 105/1-03

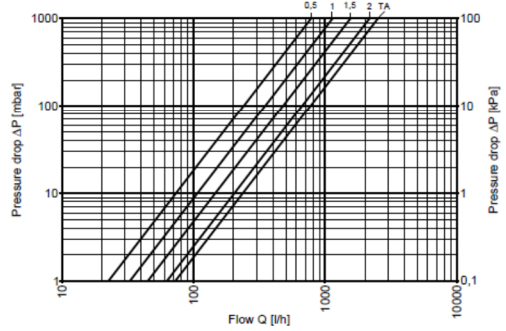

serie 105/1-04

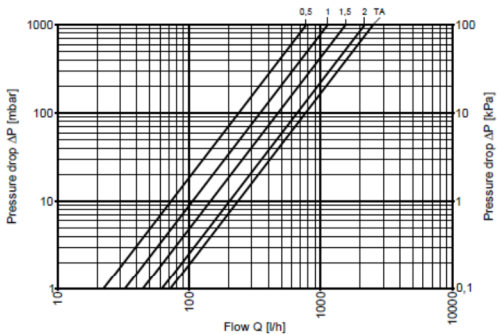

serie 105/1-045

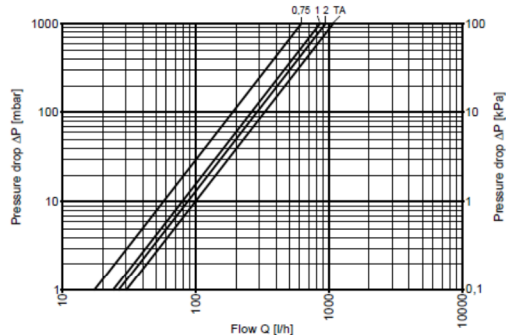

serie 107/1-03

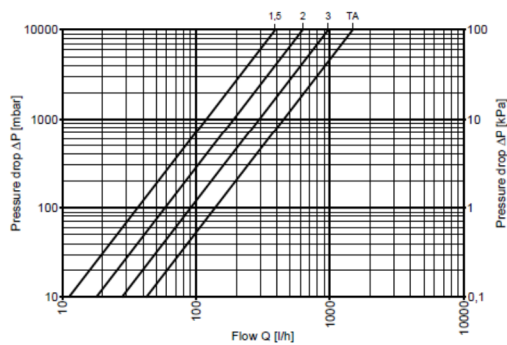

serie 107/1-04

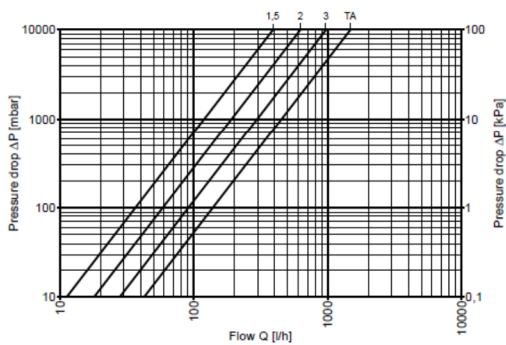

serie 107/1-045

Art. 100/1 Angle valve for iron pipe.



Manual angle valve for radiators.
Connections for iron pipe 3/8", 1/2", 3/4".
Radiator connections 3/8", 1/2", 3/4" with union and rubber seal.
Chrome-plated brass valve body, ABS knob white RAL9010.
Adjustment stem with EPDM O-Ring seal.
Maximum operating temperature 100°C, maximum operating pressure 10 bar.

Art. 101/1 Angle lockshield valve for iron pipe.



Angle lockshield valve.
Connections for iron pipe 3/8", 1/2", 3/4".
Radiator connections 3/8", 1/2", 3/4" with union and rubber seal.
Chrome-plated brass valve body, ABS protection cap white RAL9010.
Adjustment stem with EPDM O-Ring seal.
Maximum operating temperature 100°C, maximum operating pressure 10 bar

Art. 102/1 Straight valve for iron pipe.



Manual straight valve for radiators.
Connections for iron pipe 3/8", 1/2", 3/4".
Radiator connections 3/8", 1/2", 3/4" with union and rubber seal.
Chrome-plated brass valve body, ABS knob white RAL9010.
Adjustment stem with EPDM O-Ring seal.
Maximum operating temperature 100°C, maximum operating pressure 10 bar.

Art. 103/1 Straight lockshield valve for iron pipe.



Straight lockshield valve.
Connections for iron pipe 3/8", 1/2", 3/4".
Radiator connections 3/8", 1/2", 3/4" with union and rubber seal.
Chrome-plated brass valve body, ABS protection cap white RAL9010.
Adjustment stem with EPDM O-Ring seal.
Maximum operating temperature 100°C, maximum operating pressure 10 bar.

Art. 104/1 Angle valve for copper, PEX and multilayer pipe.



Manual angle valve for radiators.
Connections for copper, PEX and multilayer pipe 1/2", 3/4"E for pipe Ø10 to Ø21 mm.
Radiator connections 3/8", 1/2" with union and rubber seal.
Chrome-plated brass valve body, ABS knob colour white RAL9010.
Adjustment stem with EPDM O-Ring seal.
Maximum operating temperature 100°C, maximum operating pressure 10 bar.

Art. 105/1 Angle lockshield valve for copper, PEX and multilayer pipe.



Angle lockshield valve.
Connections for copper, PEX and multilayer pipe 1/2", 3/4"E.
Radiator connections 3/8", 1/2" with union and rubber seal.
Chrome-plated brass valve body, ABS protection cap white RAL9010.
Adjustment stem with EPDM O-Ring seal.
Maximum operating temperature 100°C, maximum operating pressure 10 bar.

Art. 106/1 Straight valve for copper, PEX and multilayer pipe.



Manual straight valve for radiators.
Connections for copper, PEX and multilayer pipe 1/2", 3/4"E for pipe Ø10 to Ø21 mm.
Radiator connections 3/8", 1/2" with union and rubber seal.
Chrome-plated brass valve body, ABS knob colour white RAL9010.
Adjustment stem with EPDM O-Ring seal.
Maximum operating temperature 100°C, maximum operating pressure 10 bar.

Art. 107/1 Straight lockshield valve for copper, PEX and multilayer pipe.



Straight lockshield valve.
Connections for copper, PEX and multilayer pipe 1/2", 3/4"E.
Radiator connections 3/8", 1/2" with union and rubber seal.
Chrome-plated brass valve body, ABS protection cap white RAL9010.
Adjustment stem with EPDM O-Ring seal.
Maximum operating temperature 100°C, maximum operating pressure 10 bar.